

ANCHORING DETAILS ARE FOR REFERENCE ONLY. FINAL SPECIFICATIONS AND DETAILS SHOULD BE APPROVED BY A LICENSED ENGINEER.

TYPE 31 TORQUE REQUIREMENTS:

- 3/16" DIA. = 35 TO 40 IN. LBS.
- 1/4" DIA. = 70 TO 80 IN. LBS.
- 3/8" DIA. = 200 TO 220 IN. LBS
- 1/2" DIA. = 400 IN. LBS

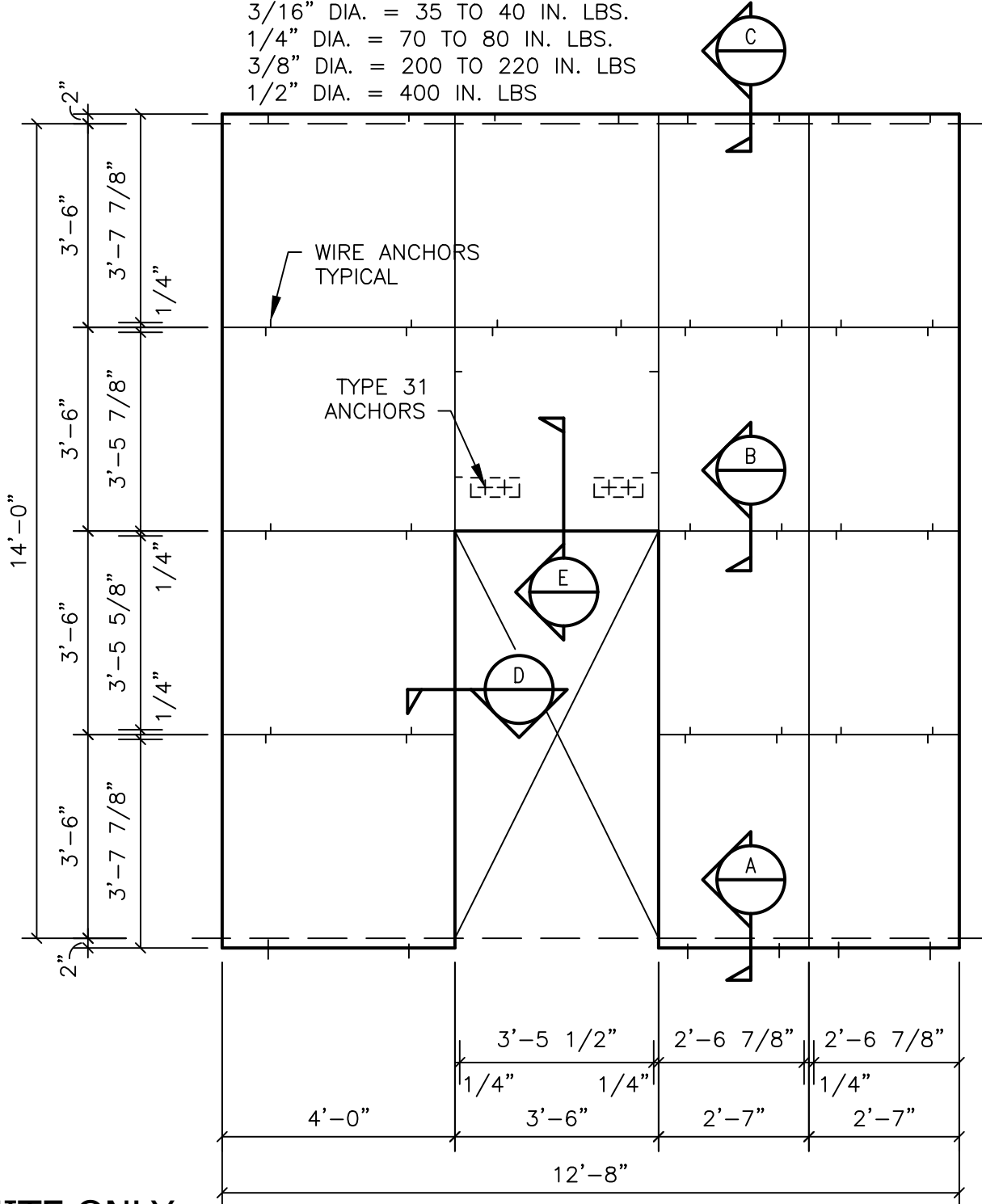

GRANITE ONLY

DR-040(10Feb25)

DESCRIPTION:

EXAMPLE INTERIOR WALL ELEVATION
20mm

SHEET #:

SCALE:

3/8" = 1'-0"

DRAWN BY:

LB/KM

DATE:

3/6/2025



COLDSPRING®

17482 GRANITE WEST ROAD, COLD SPRING, MN 56320
PHONE 320.685.3621 | WWW.COLDSPRINGUSA.COM