

ANCHORING DETAILS ARE FOR REFERENCE ONLY. FINAL SPECIFICATIONS AND DETAILS SHOULD BE APPROVED BY A LICENSED ENGINEER.

TYPE 31 TORQUE REQUIREMENTS:  
 3/16" DIA. = 35 TO 40 IN. LBS.  
 1/4" DIA. = 70 TO 80 IN. LBS.  
 3/8" DIA. = 200 TO 220 IN. LBS  
 1/2" DIA. = 400 IN. LBS

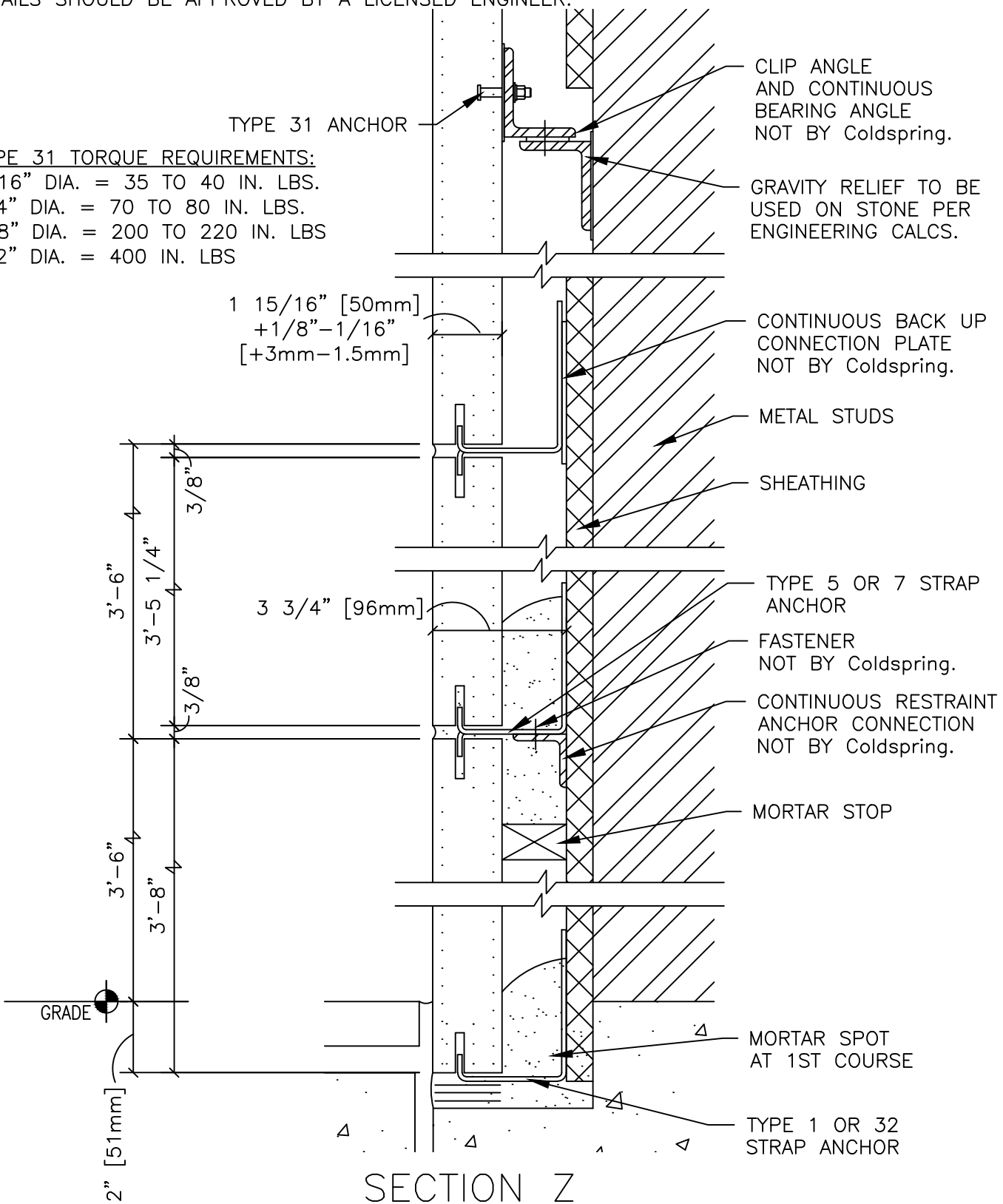

SECTION Z

DESCRIPTION:  
 EXAMPLE EXTERIOR WALL - SECTION Z  
 50mm

SCALE:  
 3" = 1'-0"

DRAWN BY:  
 LB/KM

DATE:  
 9-18-13



**COLDSPRING™**  
 17482 GRANITE WEST ROAD, COLD SPRING, MN 56320-4578  
 PHONE (320) 685-3621, FAX (320) 685-5052  
 WWW.COLDSPRINGUSA.COM